

USE AND MAINTENANCE INSTRUCTION MANUAL

EVOLUTION NO-SMOKE

TABLE OF CONTENTS

1.0 INTRODUCTION	3
20 FUNCTIONAL DESCRIPTION.....	3
3.0 PRELIMINARY INSPECTION AND ASSEMBLY.....	3
3.1 EVOLUTION NO-SMOKE trolley version	3
3.2 EVOLUTION NO-SMOKE wall version	5
3.3 ASSEMBLY PROCEDURE: EVOLUTION NO-SMOKE ON A STAND	6
3.4 ASSEMBLY PROCEDURE: EVOLUTION NO-SMOKE AND NO-SMOKE FAN	7
3.5 ASSEMBLY PROCEDURE: EVOLUTION NO-SMOKE ON WALL SHELF	10
3.6 ASSEMBLY PROCEDURE: EVOLUTION NO-SMOKE ON A TROLLEY	11
3.7 ASSEMBLY PROCEDURE: EVOLUTION NO-SMOKE TO ARM	11
4.0 EVOLUTION NO-SMOKE WITH HOOD AND LIGHT (OPTIONAL).....	12
5.0 USE AND RESTRICTIONS	13
6.0 CUSTOMISED CALIBRATIONS.....	14
6.1 HOOD CALIBRATION	14
6.2 JOINT 1 CALIBRATION	14
6.3 JOINT 2 CALIBRATION	16
7.0 MAINTENANCE	16
8.0 MARKINGS AND CERTIFICATIONS.....	17
9.0 SYMBOLS.....	17
10.0 TROUBLESHOOTING	17
11.0 LIST OF MATERIALS AND EXPLODED DRAWINGS.....	18



ANTIPOLLUTION SYSTEMS

1.0 INTRODUCTION

This manual contains information for correct use of the machine. Users are asked to carefully read the entire manual and follow the instructions it contains. Keep the manual in an appropriate place and protect it from damage. This manual can be changed without notice to include variations and improvements to previously delivered units.

2.0 FUNCTIONAL DESCRIPTION

EVOLUTION NO-SMOKE fume extraction arms are designed to convey locally produced pollutants towards specific filtering and deodorising systems. The arms stand alone (by equipping each with a fan) or form a centralised system.

3.0 PRELIMINARY INSPECTION AND ASSEMBLY

The EVOLUTION NO-SMOKE arm is delivered in a tough cardboard box.

3.1 EVOLUTION NO-SMOKE trolley version

3.1.1 EVOLUTION NO-SMOKE

Open the package and proceed as follows:

- Remove the protective foam
- Lift the EVOLUTION NO-SMOKE arm carefully
- Make sure that the package includes:
- 1 bag containing 8 M8x40 hex head screws (code 8013000037)
- 1 calibration key (dwg. 2).

3.1.2 EVOLUTION NO-SMOKE Triax

Open the package and proceed as follows:

- Remove the protective foam
- Lift the EVOLUTION NO-SMOKE arm carefully
- Fasten part 1 (dwg. 1) to part 2 (dwg. 1) using bolt 3 and nut 4 (dwg. 1).
N.B. Insert part 5 as shown in dwg. 1.
- Make sure that the package includes:
- 1 bag containing 8 M8x40 hex head screws (code 8013000037)
- 1 calibration key (dwg. 2).

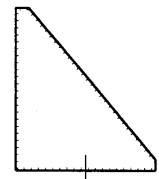
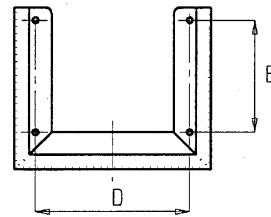
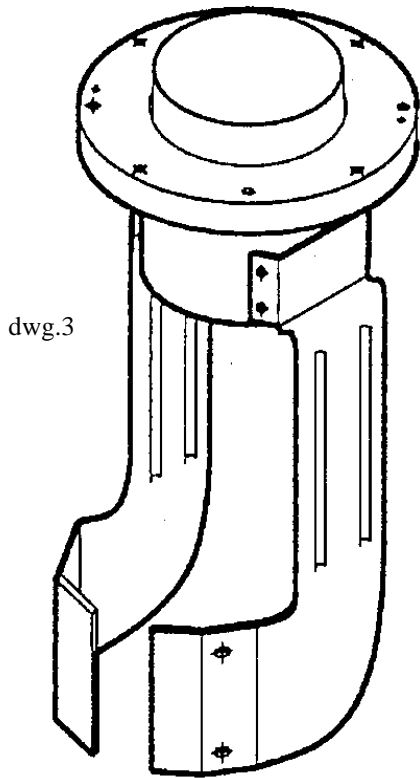
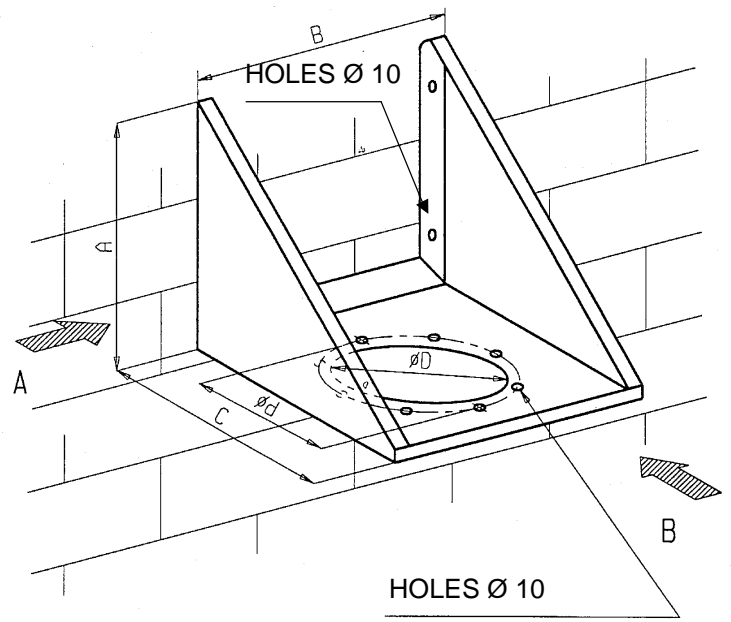
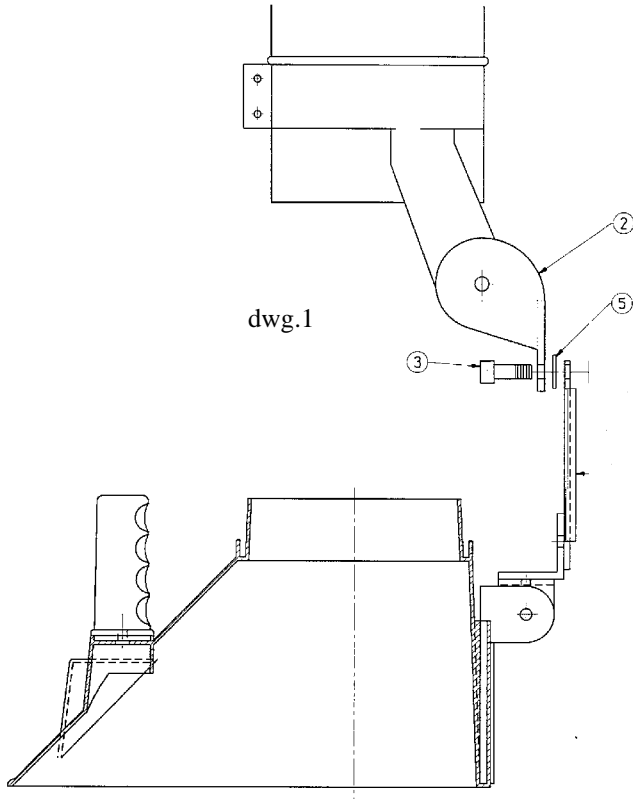

Arm shelf	A	B	C	Ø D	Ø d	Nr HOL ES	O	E
Ø 100	153	186	206	120	150	4	120	75
Ø 125	253	306	296	160	216	8	240	175
Ø 150				142				
Ø 180		346	336	206	268	12	280	
Ø 200								

3.2 EVOLUTION NO-SMOKE wall version

3.2.1 EVOLUTION NO-SMOKE

Open the package and proceed as follows:

- Remove the protective foam
- Lift the EVOLUTION NO-SMOKE arm carefully
- Check that the slewing bearing (dwg. 3) is included.
- Make sure that the package includes:
- 1 bag containing:
 - 8 M8x40 hex head screws (code 8013000037)
 - 12 nuts and washers M8 (code 8003000017)
 - 4 M8x16 socket head screws (code 8013020003)
- 1 bag containing:
 - 1 partially threaded socket head screw L = 70 M5
 - 2 shims \varnothing 8 L = 13
 - 1 flat washer \varnothing ext. 10 \varnothing int. 6
 - 1 lock nut M5
- 1 calibration key (dwg. 2).

3.2.2 EVOLUTION NO-SMOKE Triax

Open the package and proceed as follows:

- Remove the protective foam
- Lift the EVOLUTION NO-SMOKE arm carefully
- Check that the slewing bearing (dwg. 3) is included.
- Fasten part 1 (dwg. 1) to part 2 (dwg. 1) using bolt 3 and nut 4 (dwg. 1).
N.B. Insert part 5 as shown in dwg. 1.
- Make sure that the package includes:
- 1 bag containing:
 - 8 M8x40 hex head screws (code 8013000037)
 - 12 nuts and washers M8 (code 8003000017)
 - 4 M8x16 socket head screws (code 8013020003)
- 1 bag containing:
 - 1 partially threaded socket head screw L = 70 M5
 - 2 shims \varnothing 8 L = 13
 - 1 flat washer \varnothing ext. 10 \varnothing int. 6
 - 1 lock nut M5
- 1 calibration key (dwg. 2).



USE SUITABLE LIFTING MEANS FOR HANDING THE UNIT. ADOPT ALL THE NECESSARY SAFETY PRECAUTIONS SPECIFIED FOR CONSTRUCTION SITE ACTIVITIES.

Remove the material from the packaging and check that it was not damaged during transportation. Check completeness of the supply against the list of materials. Please inform our retailer as soon as possible if problems are found, in any case no later than 10 (days) after delivery.

3.3 ASSEMBLY PROCEDURE: EVOLUTION NO-SMOKE ON A STAND

The EVOLUTION NO-SMOKE extraction arm is supplied either as shown in paragraph 3.2.1 or in paragraph 3.2.2 according to the purchased model.

Proceed as follows to fasten the EVOLUTION NO-SMOKE arm to an (optional) Coral stand:

- Fasten the stand in the required position with appropriate bolts (the bolts are not provided by Coral, cf. dwg. 5).
- Fasten the Coral shelf (optional, dwg. 4) to the shelf holder plate (1, dwg. 5) with 4 M8x40 hex head bolts 1, as shown in dwg. 6.
- Take the slewing bearing 3 from the previously opened box and fasten it to the shelf on the wall using the M8x40 screws and M8 nuts and washers provided with the arm, as shown in dwg. 7.
- Lift the EVOLUTION NO-SMOKE arm carefully and fasten it to the slewing bearing with support hook 1 (dwg. 6).
- Fasten the EVOLUTION NO-SMOKE arm to the slewing bearing using the M8x16 socket head screws (2) and the M8 nuts and washers (3) provided with the arm, as shown in dwg. 7.
- Fasten the hose to the slewing bearing with the clip provided with the EVOLUTION NO-SMOKE arm (dwg. 8).

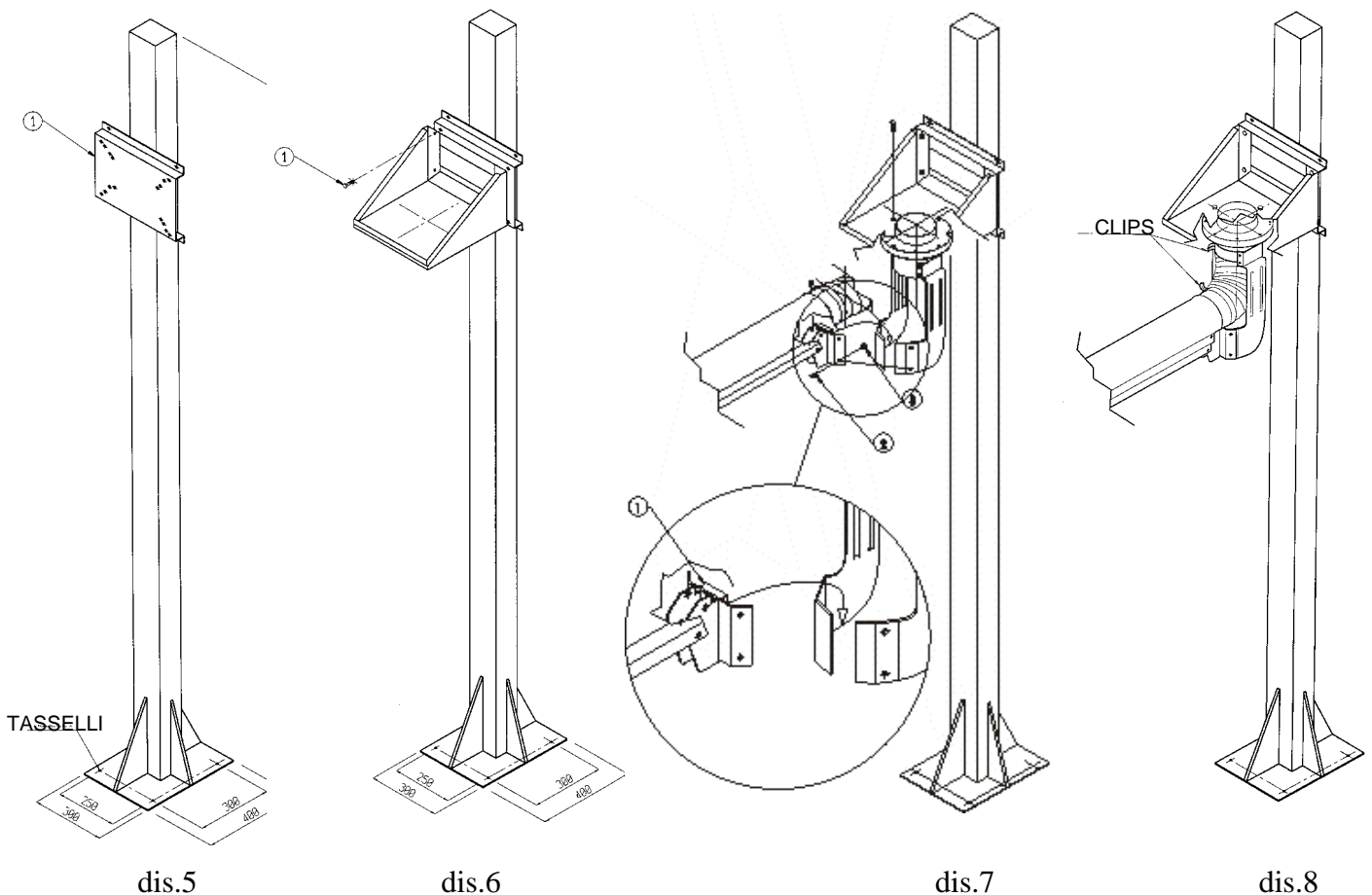



ANTIPOLLUTION SYSTEMS

3.4 ASSEMBLY PROCEDURE: EVOLUTION NO-SMOKE AND NO-SMOKE FAN

3.4.1 FAN AND ARM ASSEMBLY PROCEDURE

The EVOLUTION NO-SMOKE extraction arm is supplied either as shown in paragraph 3.2.1 or in paragraph 3.2.2 according to the purchased model.

Proceed as follows to fasten the EVOLUTION NO-SMOKE arm to an (optional) NO-SMOKE Coral fan:

- Fasten the NO-SMOKE shelf in the required position with appropriate bolts (the bolts are not provided by Coral, cf. dwg. 9).
- Fasten the NO-SMOKE fan to the shelf described above as shown in dwg. 10.

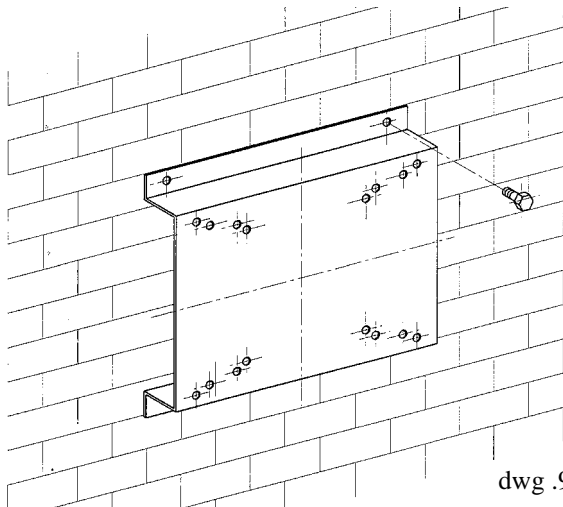

dwg. 9

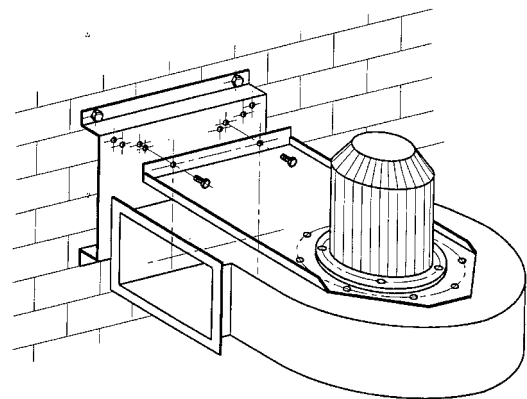

dwg. 10

- Take the slewing bearing 2 from the previously opened box and fasten it to the NO-SMOKE fan using the M8x40 screws and washers provided with the arm, as shown in dwg. 11.
- Lift the EVOLUTION NO-SMOKE arm carefully and fasten it to the slewing bearing with support hook 1 (dwg. 12).

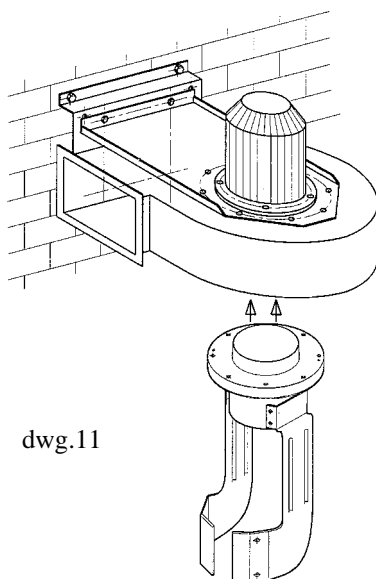

dwg. 11

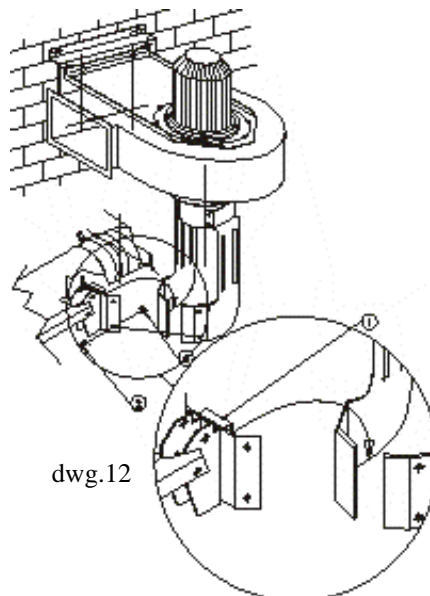

dwg. 12

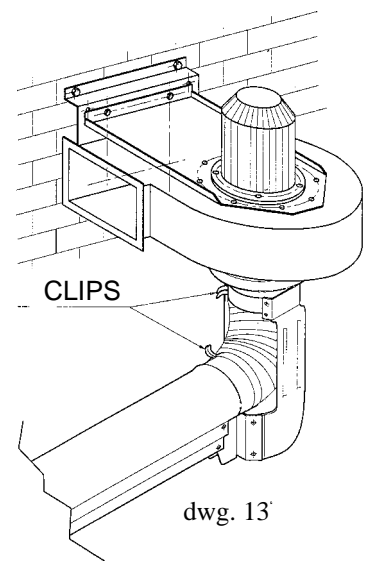

dwg. 13



ANTIPOLLUTION SYSTEMS

- Fasten the EVOLUTION NO-SMOKE arm to the slewing bearing using the M8x16 socket head screws (2) and the M8 nuts and washers (3) provided with the arm, as shown in dwg. 12.
- Fasten the hose to the slewing bearing with the clip provided with the EVOLUTION NO-SMOKE arm (dwg. 13).

3.4.2 ELECTRICAL CONNECTIONS



Proceed by electrically connecting the device according to the safety rules in force. Correct that the motor cooling fan is turning in the right direction shown by the arrow applied to the NO-SMOKE fan. Reverse the phases if the direction of rotation is not correct. No other jobs are allowed.

DIAGRAM 1

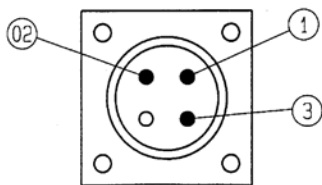
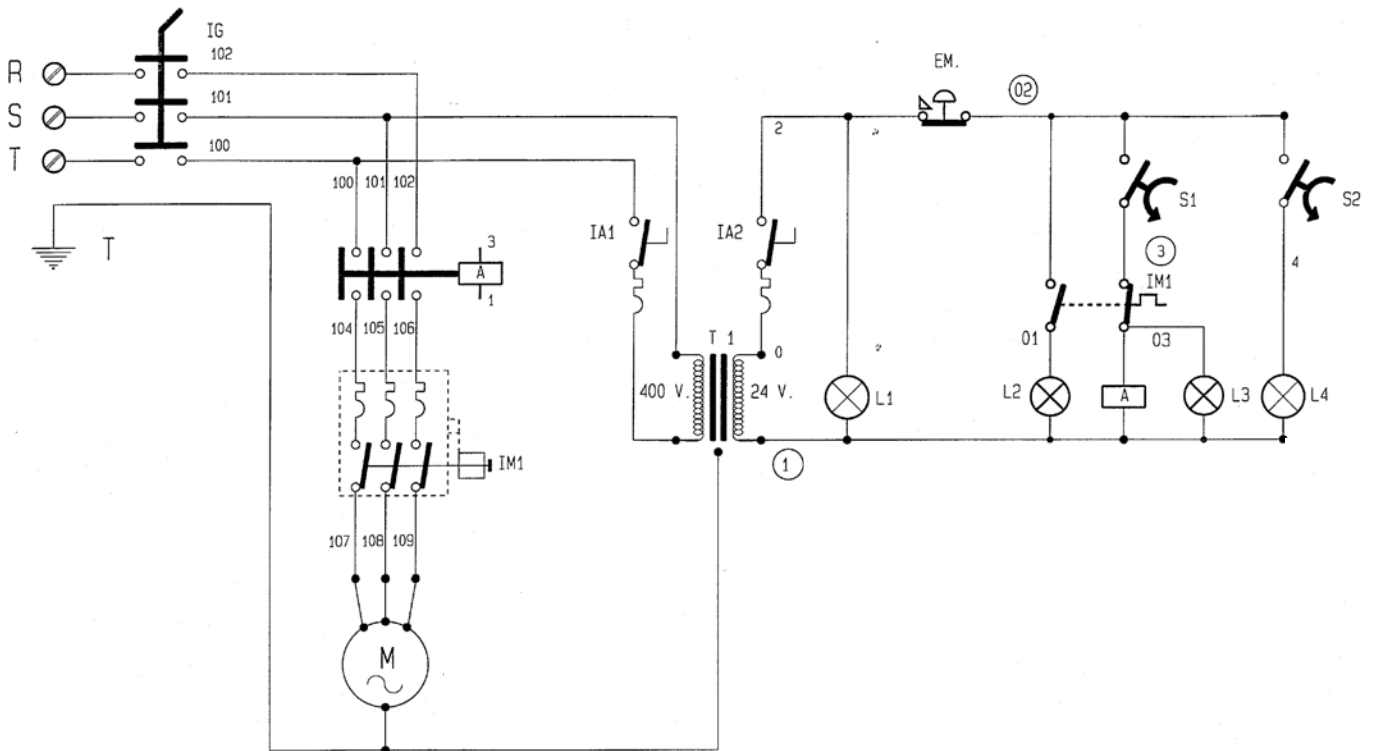

3.4.3 NO-SMOKE FAN TECHNICAL DATA (where fitted)

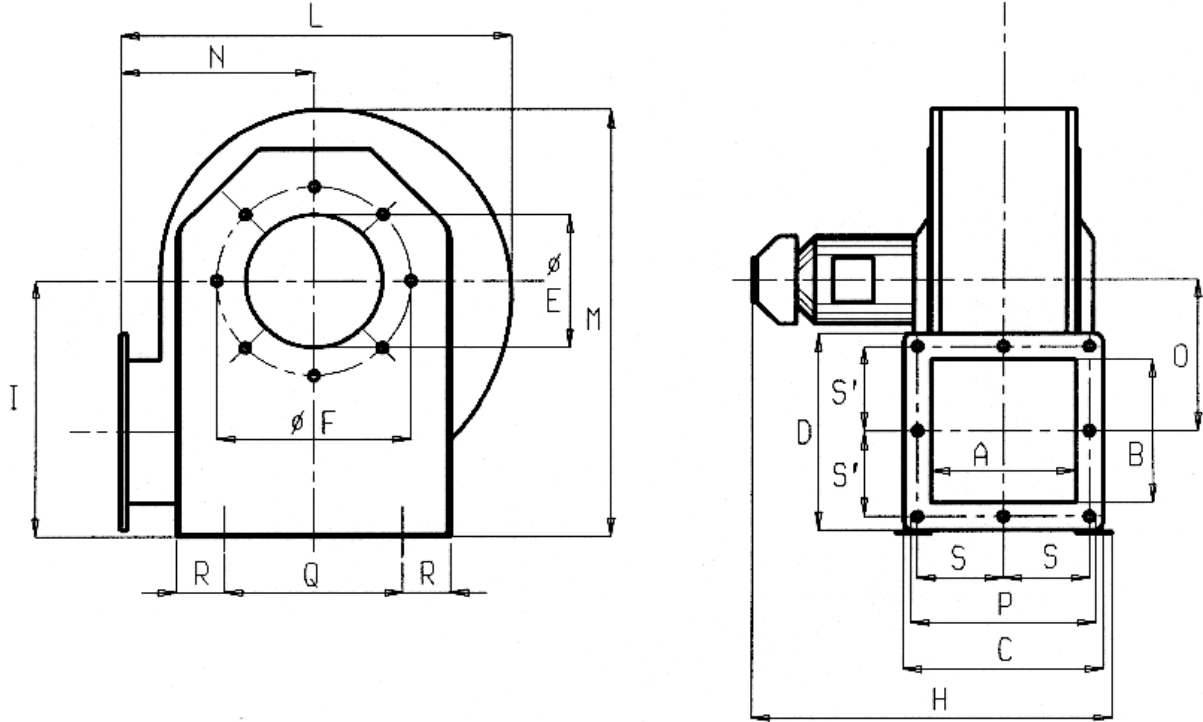

Model	A	B	C	D	ØE	ØF	H	I	L	M	N	O	P	Q	R	S	S'
Ø 100 HP 0.5	140	185	200	245	105	150	392	242	351	409	182	114	183	170	52	85	108
Ø 150 HP 0.75					162	216											
Ø 150 HP 1	160		220		152	216	432	287	429	477	212	162	204	198	53	95	
Ø 150 HP 2	180		240		153		502	378	535	619	257	227	223	278	48	105	
Ø 150 HP 3	200		260		190		246	522	412	601	685	286	258	243	320	47	115
Ø 180 HP 2					205	268											
Ø 180 HP 3																	
Ø 200 HP 2																	
Ø 200 HP 3																	

3.4.4 NO-SMOKE FANS

Model	Ø T	H fan	U	V	kW	Speed
Ø 100 HP 0.5	240	60	14	5	0.37	2800
Ø 150 HP 0.75					0.55	
Ø 150 HP 1	250	66	19	6	0.75	
Ø 150 HP 2	280	75	24	8	1.5	
Ø 150 HP 3	315	83			2.2	
Ø 180 HP 2		1.5				
Ø 180 HP 3	340	90			2.2	
Ø 200 HP 2	315	83			1.5	
Ø 200 HP 3	340	90			2.2	

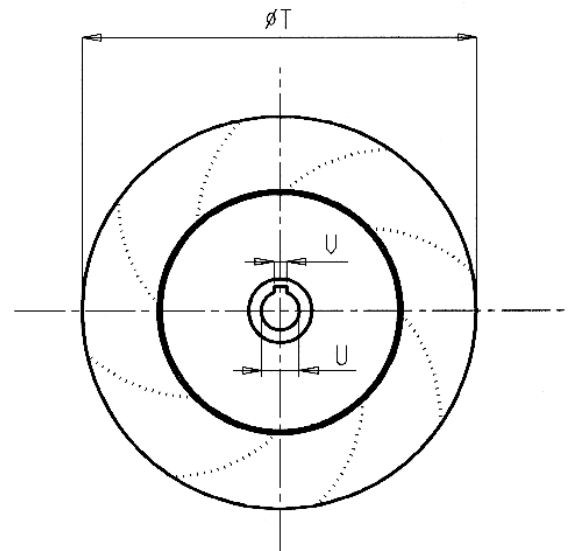



ANTIPOLLUTION SYSTEMS

3.5 ASSEMBLY PROCEDURE: EVOLUTION NO-SMOKE ON WALL SHELF

The EVOLUTION NO-SMOKE extraction arm is supplied either as shown in paragraph 3.2.1 or in paragraph 3.2.2 according to the purchased model.

Proceed as follows to fasten the EVOLUTION NO-SMOKE arm to an (optional, dwg. 2) Coral wall shelf:

- Fasten the wall shelf in the required position with appropriate bolts (the bolts are not provided by Coral, cf. dwg. 4).
- Take the slewing bearing 3 from the previously opened box and fasten it to the shelf on the wall using the M8x40 screws and M8 nuts and washers provided with the arm, as shown in dwg. 14.
- Lift the EVOLUTION NO-SMOKE arm carefully and fasten it to the slewing bearing with support hook 1 (dwg. 14).
- Fasten the EVOLUTION NO-SMOKE arm to the slewing bearing using the M8x16 socket head screws and the M8 nuts and washers provided with the arm, as shown in dwg. 14.
- Fasten the hose to the slewing bearing with the clip provided with the EVOLUTION NO-SMOKE arm (dwg. 15).

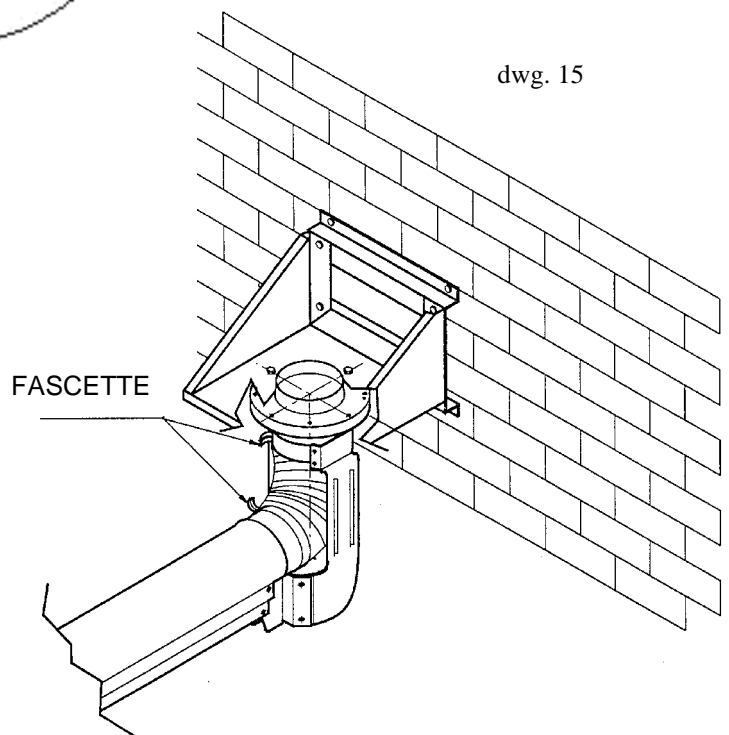
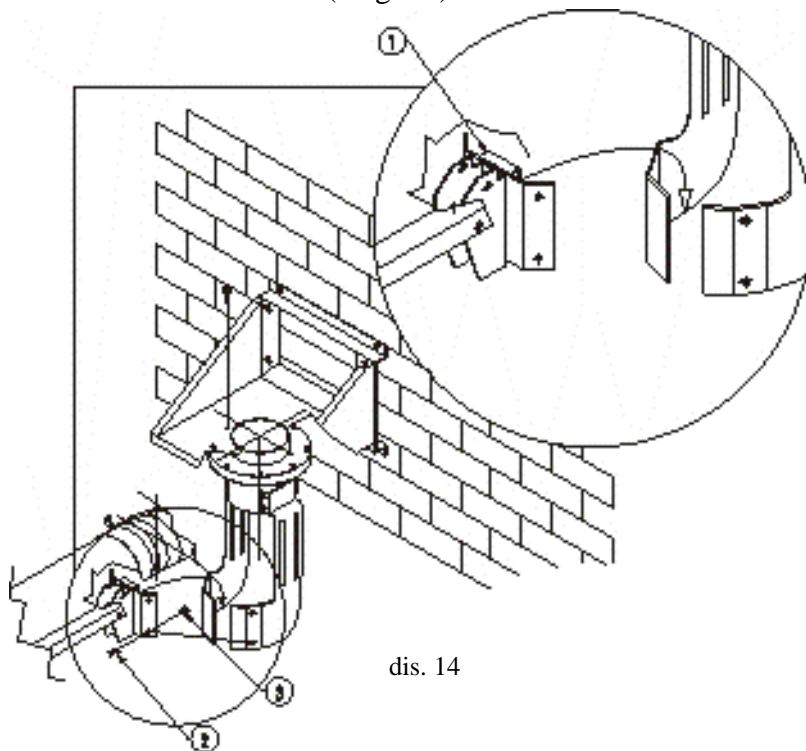



ANTIPOLLUTION SYSTEMS

3.6 ASSEMBLY PROCEDURE: EVOLUTION NO-SMOKE ON A TROLLEY

The EVOLUTION NO-SMOKE extraction arm is supplied either as shown in paragraph 3.1.1 or in paragraph 3.1.2 according to the purchased model. Proceed as follows to fasten the EVOLUTION NO-SMOKE arm to a Coral trolley:

- Take the EVOLUTION NO-SMOKE arm from the previously opened box and fasten it to the trolley as shown in dwg. 16 using the M8x40 screws (1) provided with the arm.



Follow the combinations in table 1 below to the letter to ensure safe and stable fastening of the EVOLUTION NO-SMOKE to the trolley. No other jobs are allowed.

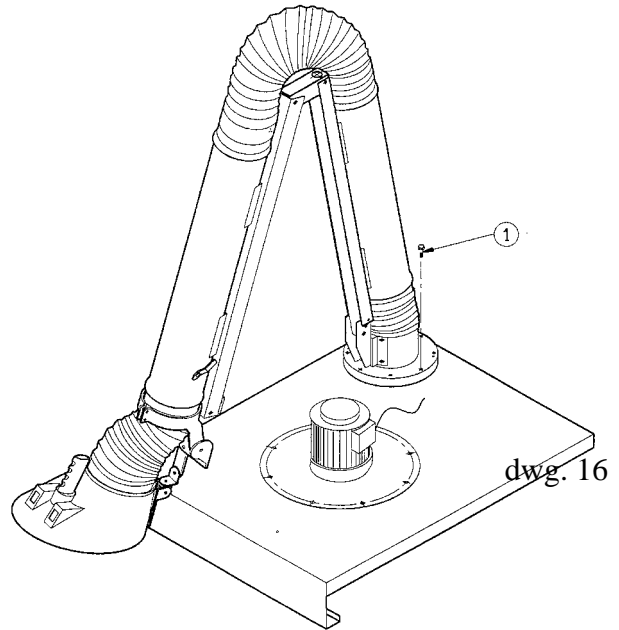

TABLE 1

Arm model	Compatible Coral trolleys
EVOLUTION NO-SMOKE 100/2.7	Grindex/S HP1.5
EVOLUTION NO-SMOKE 150/3	Cleaning No-Smoke "absolute" HP 2 - HP 3
	Cleaning No-Smoke "electrostatic" HP 1.5 - HP 2
	Cleaning No-Smoke HP 2 - HP 3
	Cleaning No-Smoke "TR" HP 2 - HP 3
	Clean-go HP 1.5
	Clean-go/E HP 1.5 1 cell / 2 cells
	Iperjet HP 2 - HP 3 - HP 4
	Iperfilter HP 2 - HP 3 - HP 4
EVOLUTION NO-SMOKE 150/4	Jetclean HP 1 - HP 2
	Iperjet HP 2 - HP 3 - HP 4
	Iperfilter HP 2 - HP 3 - HP 4
EVOLUTION NO-SMOKE 180/3	Jetclean HP 2
	Cleaning No-Smoke HP 1.5

3.7 ASSEMBLY PROCEDURE: EVOLUTION NO-SMOKE TO ARM

Refer to the Coral "BANDIERA 2000" assembly manual.



ANTIPOLLUTION SYSTEMS

4.0 EVOLUTION NO-SMOKE WITH HOOD AND LIGHT (optional)

The EVOLUTION NO-SMOKE filtering arm may be provided with hood and light. Refer to fig. 17 in this case. The EVOLUTION NO-SMOKE filtering arm is complete with a socket for powering the light. It is also provided with plug for electrical connections according to the diagram 2.



Refer to diagram 1 if the EVOLUTION NO-SMOKE arm with hood and light is used in combination with a No-Smoke fan.

LIGHT KIT LIST OF MATERIALS

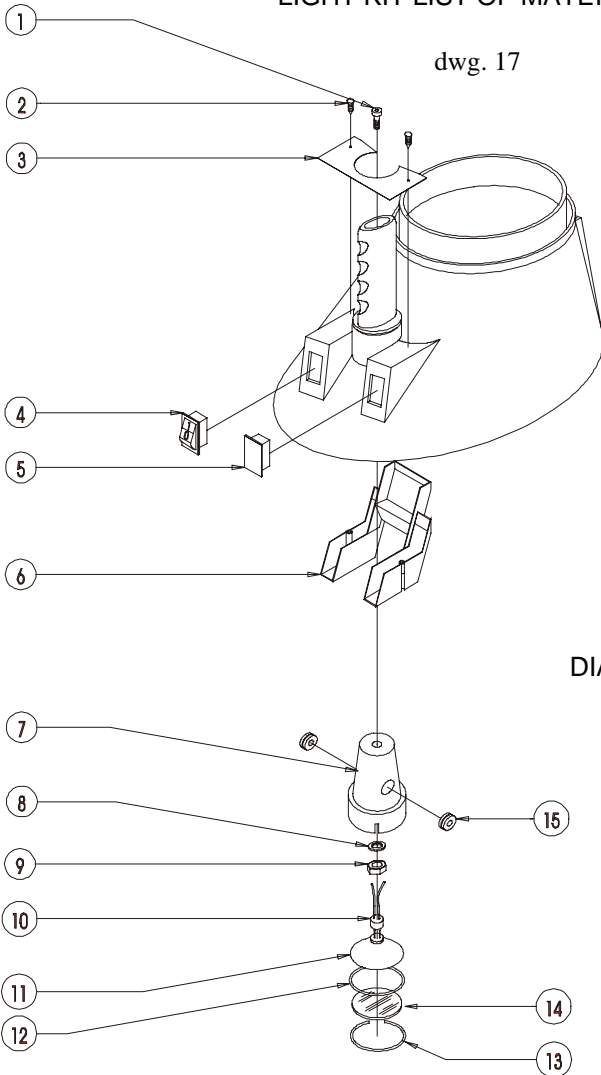

Nr.	Code	Description	Unit	Qty
1	8013050025	SCREW	item	1
2	8013060042	PARKER SCREW	item	2
3	3000002002	GUIDE WITH HOLES FOR HOOD AND LIGHT	item	1
4	7058110066	TOGGLE SWITCH 16A-250V	item	1
5	7045030029	CAP FOR HOOD	item	1
6	3000002001	PLASTIC HOOD LINER	item	1
7	3000002003	CAP LIGHT HOLDER CONE	item	1
8	8010000075	WASHER	item	1
9	8003000003	HEX NUT	item	1
10	7058220002	24V-10A HALOGEN BULB HOLDER	item	1
11	7058080026	20W-24V HALOGEN LIGHT BULB	item	1
12	7046030027	RUBBER O-RING	item	1
13	3000002005	STOP RING	item	1
14	0027000028	GLASS	item	1
15	7046030016	RUBBER GROMMET	item	2

DIAGRAM 2 - ELECTRICAL CONNECTION

ARM CONNECTION DETAIL

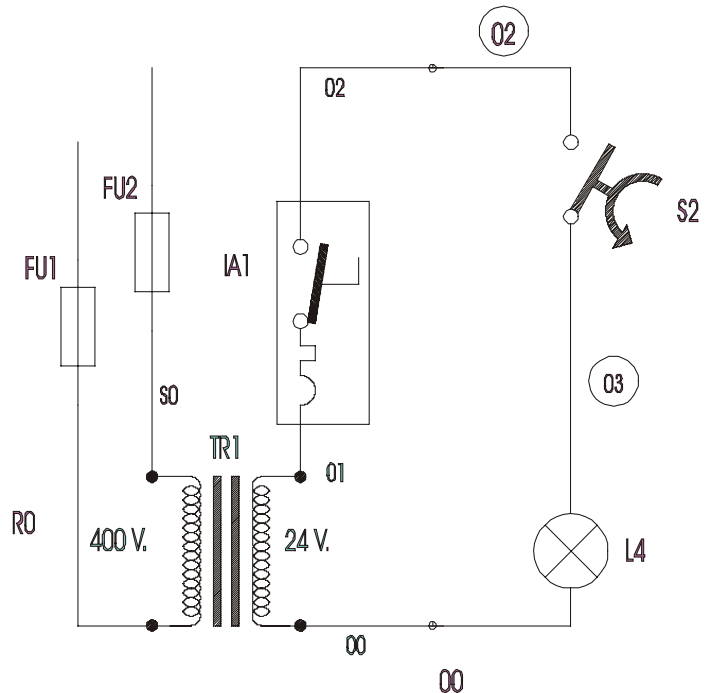
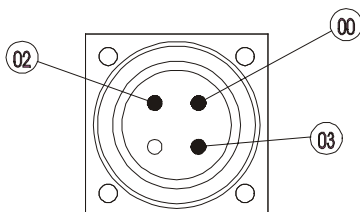



ANTIPOLLUTION SYSTEMS

5.0 USE AND RESTRICTIONS

The EVOLUTION NO-SMOKE arm was designed to extract polluting agents such as:

- fumes
- vapours
- metallic powders
- wood
- plastic

of granulometry up to 10 μm mixed in air.



The EVOLUTION NO-SMOKE filtering arm is not designed to process flammable and/or explosive and/or toxic vapours by nature or reaction. The suction hood should be equipped with the spark stopper mesh 6 shown in the dwg. 18 for extraction of incandescent powders. Contact the Coral S.p.A. technical office beforehand in all cases.



Connect the filtering arm electrically to earth. Connect the contact points with a suitable cross-section braid fastened to the unit. Make sure continuity is ensured



The end of travel pin (1, dwg. 19) is only needed when the NO-SMOKE fan is fitted to avoid damaging the arm during working operations.

Improper use includes actions which effect functionality, integrity and safety of the filtering arm and extension, the internal electrical and mechanical apparatuses and the control and connection elements. Coral S.p.A. Technical Assistance is at your service for additional information on product use.

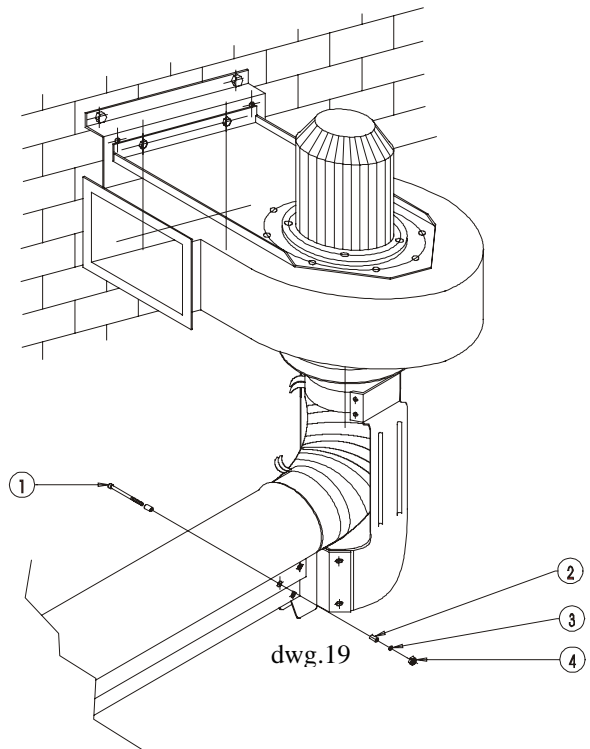
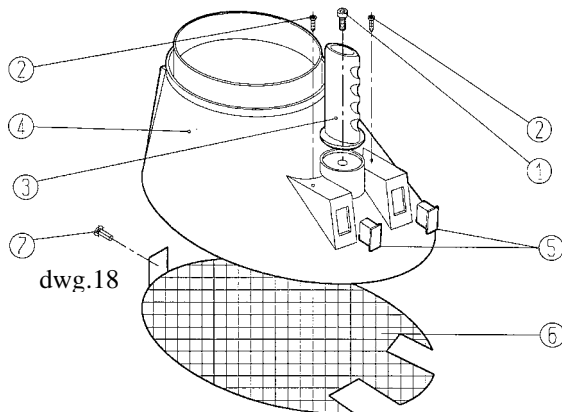



ANTIPOLLUTION SYSTEMS

6.0 CUSTOMISED CALIBRATIONS

The mobile parts of the EVOLUTION NO-SMOKE arm do not need to be calibrated before use but some standard calibrations may be performed directly by the user to customise the device. Refer to paragraph 6.1 for adjusting the mobile parts of the suction hood and paragraph 6.2 for customising the arm movement pressure to customise the mobile parts of the EVOLUTION NO-SMOKE arm.

6.1 HOOD CALIBRATION

Adjust the brake pressure delicately as shown in dwg. 20.

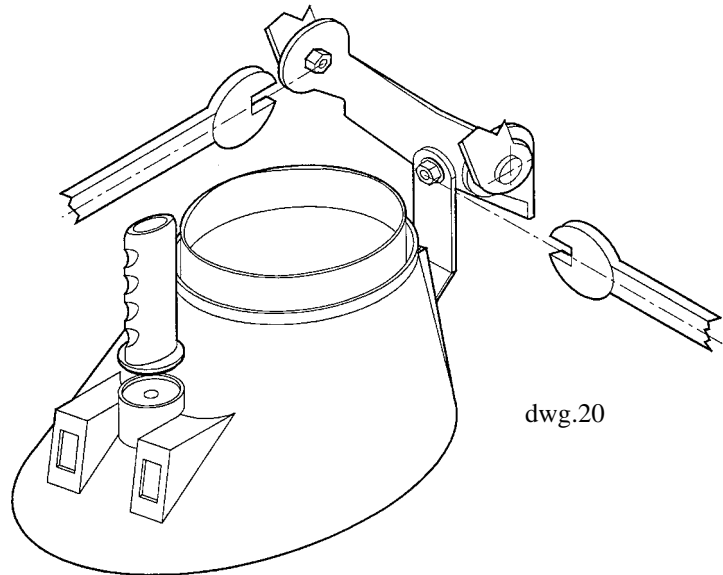

6.2 JOINT 1 CALIBRATION

- Position the EVOLUTION NO-SMOKE arm as shown in dwg. 21a or 21b according to the purchased model.
- Remove the spring cover on the upper part of joint 1 using a flat tip screwdriver as shown in dwg. 21a or 21b according to the purchased model.

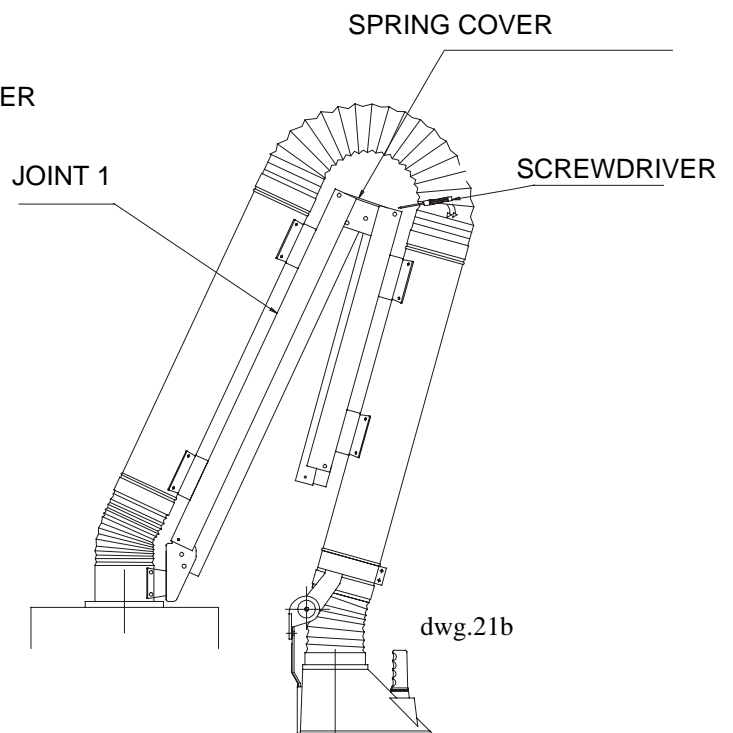
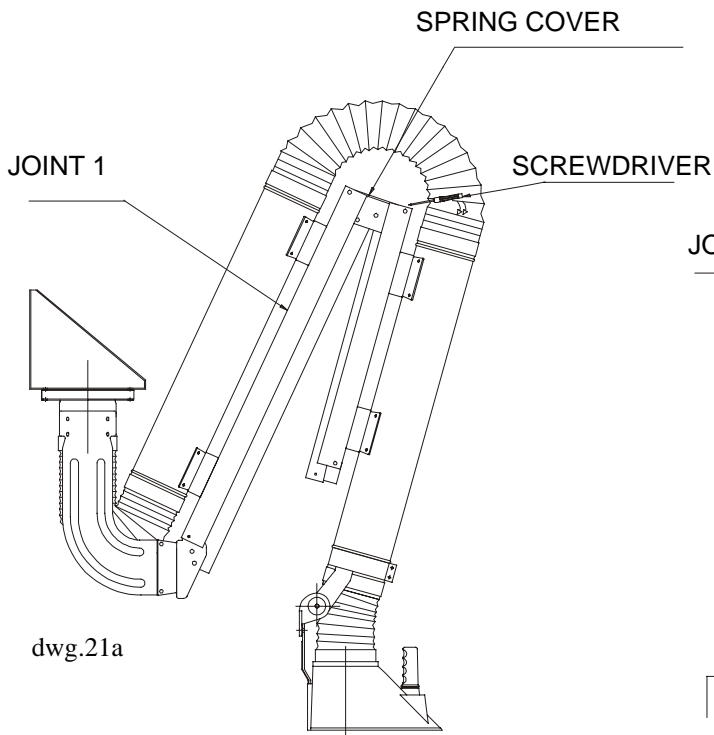

- With reference to dwg. 22a and 22b, move the hose connecting the two sections of the arm (if required, remove a fastening clip and remove the hose from one of the pipe ends). Insert the socket spanner (dwg. 2) in the recess housing the spring and fit it on the calibration nut. Insert a screwdriver from the side through the socket spanner and follow the instructions given in table 2.

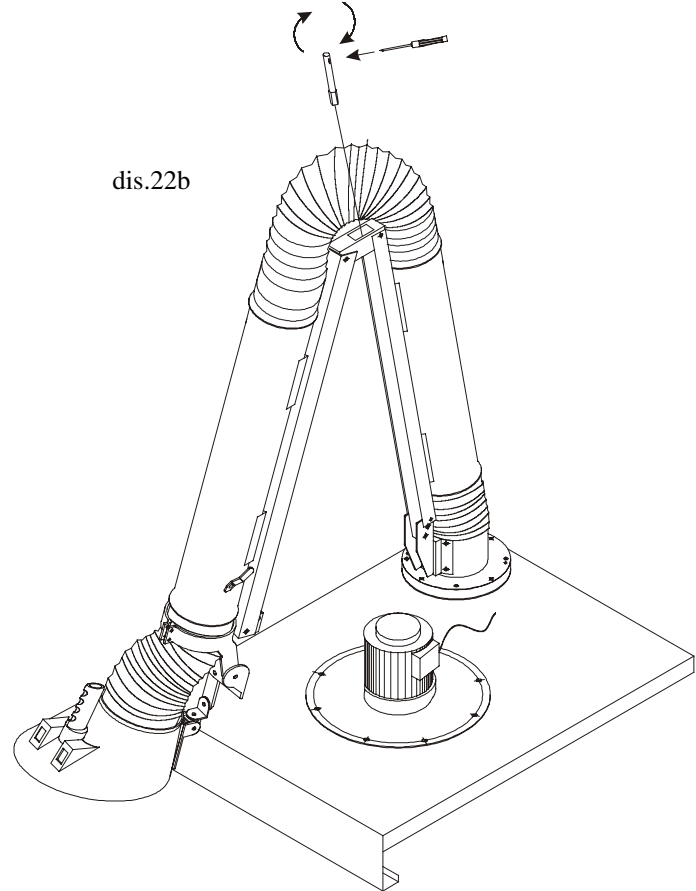
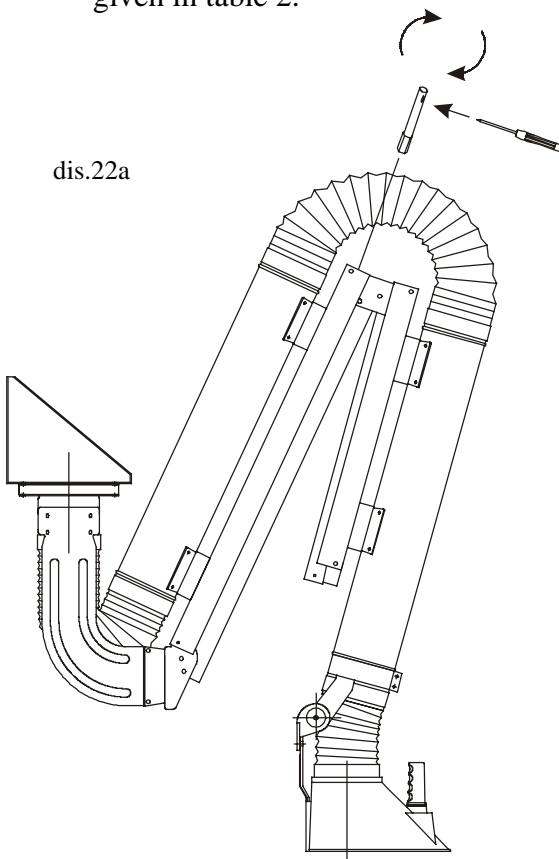

TABLE 2

Operation	Effect
Turn the calibration tool clockwise.	To increase the effort required by the operator to take the arm to the position shown in dwg. 23a or 23b according to the purchased model and to decrease the effort required by the operator to return the arm to the position shown in dwg. 21a or 21b at the same time.
Turn the calibration tool anticlockwise.	To increase the effort required by the operator to take the arm to the position shown in dwg. 21a or 21b according to the purchased model and to decrease the effort required by the operator to return the arm to the position shown in dwg. 23a or 23b at the same time.



ANTIPOLLUTION SYSTEMS

6.3 JOINT 2 CALIBRATION

Proceed as follows to calibrate joint 2:

- Position the EVOLUTION NO-SMOKE arm as shown in dwg. 23a or 23b according to the purchased model.
- Remove the spring cap from the upper part of joint 2.
- Insert the socket spanner (dwg. 2) in the recess housing the spring and fit it the calibration nut. Insert a screwdriver from the side through the socket spanner and follow the instructions given in table.

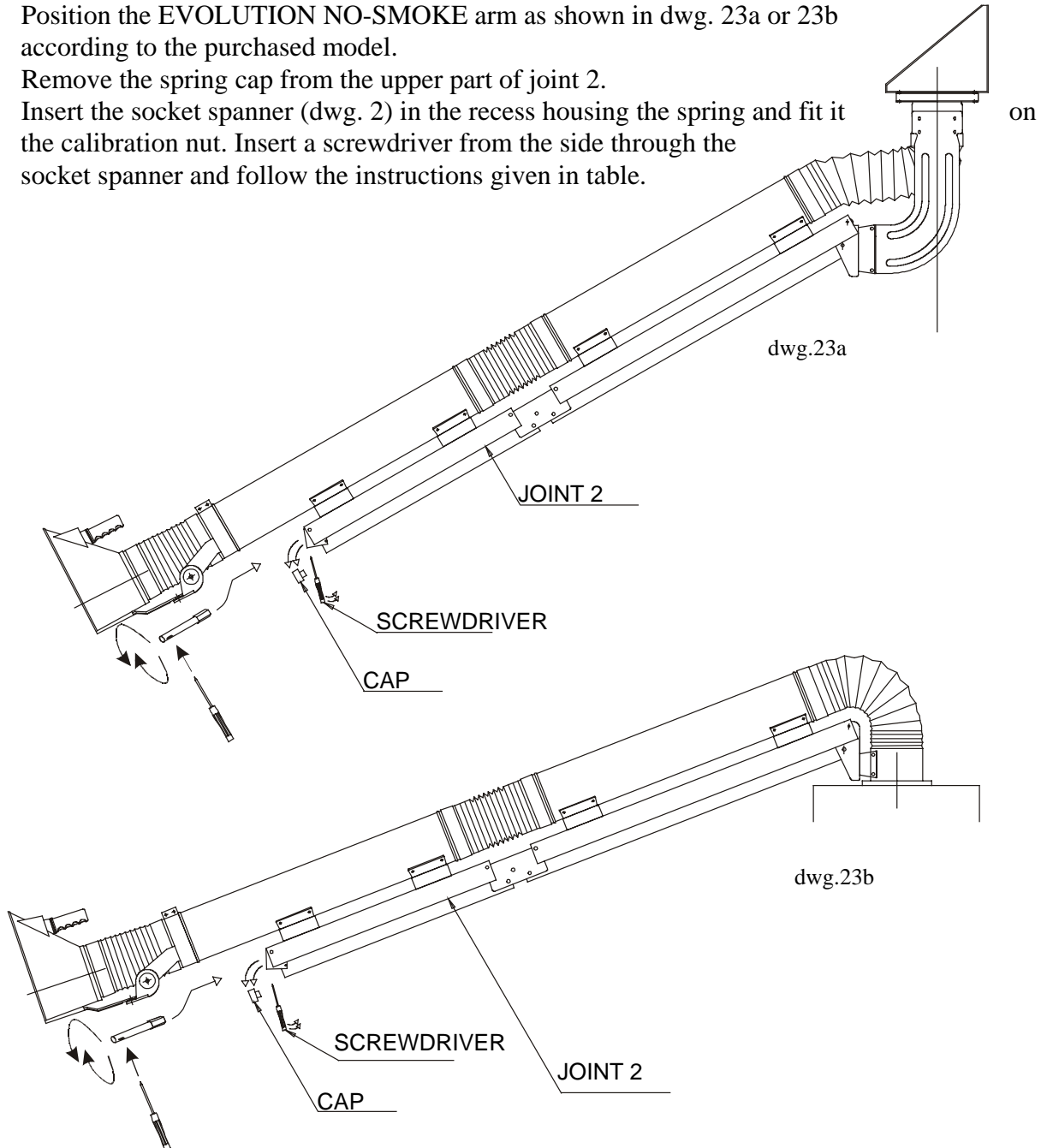

7.0 MAINTENANCE



Do not perform maintenance operations while the system is either running or connected to the electrical mains. You are advised to lock the controls out to avoid undesired start-up during maintenance operations.

EVOLUTION NO-SMOKE filtering arms are specifically designed to be routine maintenance-free. The following interventions are recommended:



ANTIPOLLUTION SYSTEMS

- Check the electrical power wire conditions (where applicable) every day.
- Check correct calibration of the filtering arm once a month.
- Check conditions of flexible channel sections once a month.
- Check wear of suction hood joints and hood clutches once a month.
- Check wear of slewing bearing once a month.
- Check conditions of internal adjustment shutter once a month.

8.0 MARKINGS AND CERTIFICATIONS

EVOLUTION NO-SMOKE was examined according to the Machinery Directive EEC 89/392 and amendments. Compliance is certified by the CE marking on the machine and the declaration of conformity which accompanies this manual.

9.0 SYMBOLS



These symbols and the accompanying text indicate potential risks deriving from disrespect of the respective instructions, specifically:



400 V

Sticker indicating that the control panel contains live parts powered at 400 V.



Sticker indicating the correct direction of rotation of the fan

10.0 TROUBLESHOOTING

N	Problem	Cause	Possible solution
1	Fan vibrates	Check is reversed vane impeller is balanced correctly	Remove motor bracket and clean vanes
2	Fan turns but suction is not sufficient	Check direction of rotation	Reverse the two phases
		Check whether air ducts are clear	Remove obstructions and adjust the calibration shutter



ANTIPOLLUTION SYSTEMS

11.0 LIST OF MATERIALS AND EXPLODED DRAWINGS

EVOLUTION (WALL MOUNTED)

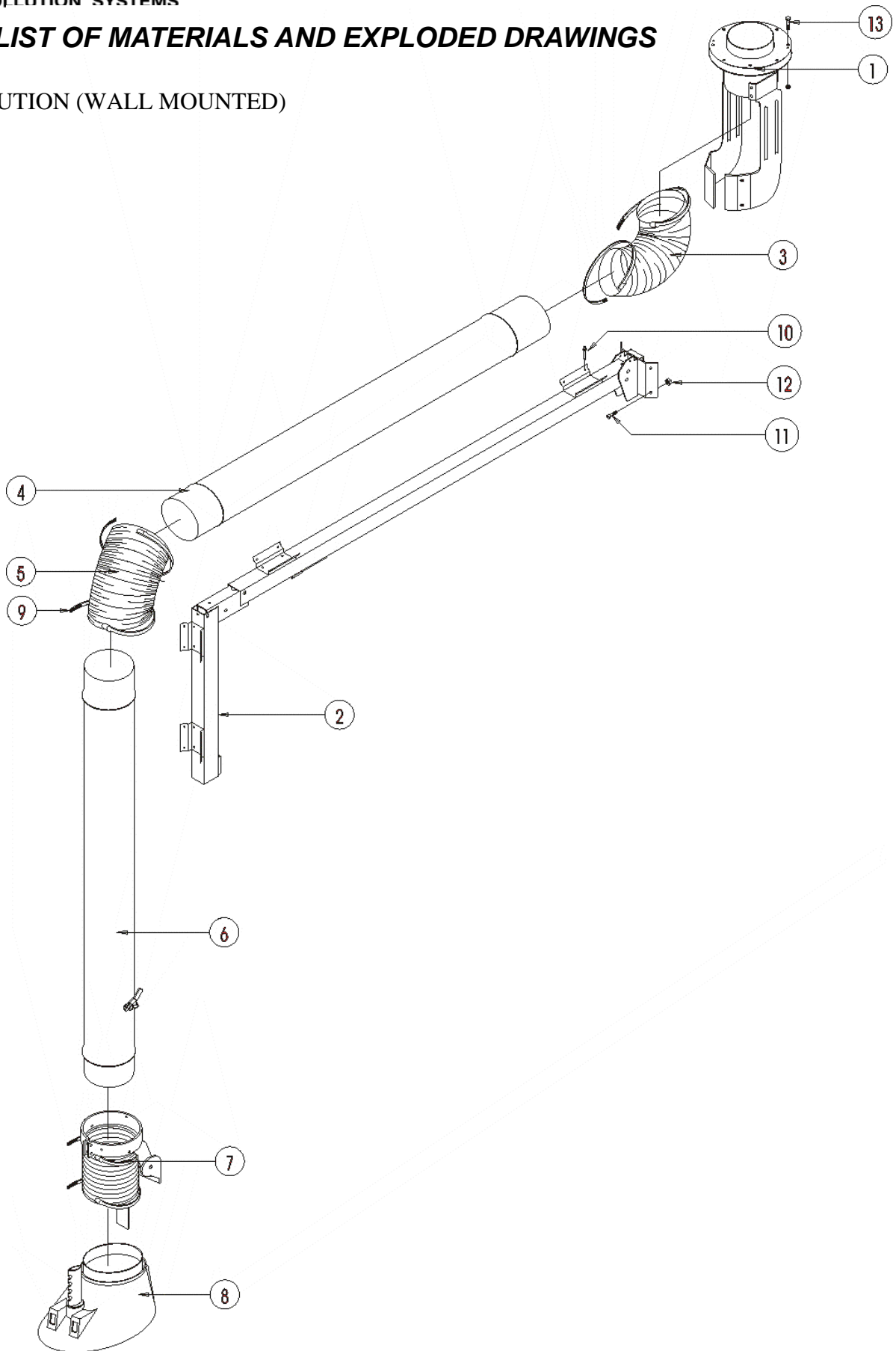

EVOLUTION (WALL MOUNTED, GALVANISED)							
Nr.	Ø125 L=3m	Ø125 L=4m	Ø150 L=3m	Ø150 L=4m	Description	Unit	Qty.
	Code	Code	Code	Code			
1.	3000000817		3000000676		BRACKET + SLEWING BEARING BLOCK	item	1
2.	3000001136	3000001137	3000000684	3000000697	JOINTED MOUNT	item	1
3.	3000000831		3000000637		FLEXIBLE HOSE	item	1
4.	3000001248	3000001249	3000000665	3000000700	GALVANISED STEEL PIPE	item	1
5.	3000000830		3000000638		FLEXIBLE HOSE	item	1
6.	3000003111	3000003112	3000002793	3000002932	GALVANISED PIPE AND SHUTTER	item	1
7.	3000003586		3000002950		COMPLETE FINAL JOINT	item	1
8.	3000003528		3000002727		COMPLETE HOOD	item	1
9.	7035000061		7045030023		HOSE CLIPS	item	4
10.	8009000012				RIVET	item	32
11.	8013020003				SCREW	item	4
12.	8003000017				NUT AND WASHER	item	12
13.	8013000037				SCREW	item	8

EVOLUTION (WALL MOUNTED. PRE-COATED)										
Nr.	Ø100 L=2.1m	Ø100 L=2.7m	Ø125 L=3m	Ø125 L=4m	Ø150 L=3m	Ø150 L=4m	Description	Unit	Qty.	
	Code	Code	Code	Code	Code	Code				
1.	3000006605	3000001224	3000000817		3000000676		BRACKET + SLEWING BEARING BLOCK	item	1	
	3000009194	/					BRACKET ATTACHMENT EXTENSION	item	1	
2.	3000009814	3000001136		3000001137	3000000684	3000000697	JOINTED MOUNT	item	1	
3.	3000001066	3000001065	3000000831		3000000637		FLEXIBLE HOSE	item	1	
4.	3000001060	3000002717	3000001244	3000001245	3000000664	3000000698	PRE-COATED STEEL PIPE	item	1	
5.	3000001065	3000010459	3000000830		3000000638		FLEXIBLE HOSE	item	1	
6.	3000003096	3000002718	3000003109	3000003110	3000002724	3000002787	PRE-COATED PIPE AND SHUTTER	item	1	
7.	3000002674		3000003586		3000002950		COMPLETE FINAL JOINT	item	1	
8.	3000002675		3000003528		3000002727		COMPLETE HOOD	item	1	
9.	7035000065		7035000061		7045030023		HOSE CLIPS	item	4	
10.	8009000012				8009000012		RIVET	item	16/32	
11.	8013000029	8013020003						SCREW	item	4
12.	8003000017	8003000017						NUT AND WASHER	item	4/12
13.	/	8013000037						SCREW	item	8

EVOLUTION (WALL MOUNTED. ALUMINIUM)										
Nr.	Ø100 L=2.1m	Ø100 L=2.7m	Ø125 L=3m	Ø125 L=4m	Ø150 L=3m	Description	Unit	Qty.		
	Code	Code	Code	Code	Code					
1.	3000006605	3000001224	3000000817		3000000676	BRACKET + SLEWING BEARING BLOCK	item	1		
	3000009194	/					BRACKET ATTACHMENT EXTENSION	item	1	
2.	3000009814	3000001136		3000001137	3000000684	JOINTED MOUNT	item	1		
3.	3000001066	3000001065	3000000831		3000000637	FLEXIBLE HOSE	item	1		
4.	3000001229	3000002712	3000000826	3000000827	3000000668	ALUMINIUM PIPE	item	1		
5.	3000001065	3000010459	3000000830		3000000638	FLEXIBLE HOSE	item	1		
6.	3000003097	3000002713	3000003106	3000003107	3000002930	ALUMINIUM PIPE AND SHUTTER	item	1		
7.	3000002674		3000003586		3000002950	COMPLETE FINAL JOINT	item	1		
8.	3000002675		3000003528		3000002727	COMPLETE HOOD	item	1		
9.	7035000065		7035000061		7045030023	HOSE CLIPS	item	4		
10.	8009000012				8009000012	RIVET	item	16/32		
11.	8013000029	8013020003						SCREW	item	4
12.	8003000017	8003000017						NUT AND WASHER	item	12
13.	/	8013000037						SCREW	item	8

EVOLUTION (WALL MOUNTED, ALUMINIUM)								
Nr.	Ø150 L=4m	Ø180 L=3m	Ø180 L=4m	Ø200 L=3m	Ø200 L=4m	Description	Unit	Qty.
	Code	Code	Code	Code	Code			
1.	300000676	300000739		300000791		BRACKET + SLEWING BEARING BLOCK	item	1
2.	300000697	300000684	300000697	300000684	300000697	JOINTED MOUNT	item	1
3.	300000637	300000760		300000779		FLEXIBLE HOSE	item	1
4.	300000702	300000737	300000738	300000774	300000775	ALUMINIUM PIPE	item	1
5.	300000638	3000010466		3000010468		FLEXIBLE HOSE	item	1
6.	3000002933	3000002826	3000002820	3000002856	3000002877	ALUMINIUM PIPE AND SHUTTER	item	1
7.	3000002950	3000002825		3000002852		COMPLETE FINAL JOINT	item	1
8.	3000002727	3000002814		3000002850		COMPLETE HOOD	item	1
9.	7045030023	7035000056		7035000054		HOSE CLIPS	item	4
10.	8009000012	8009000012				RIVET	item	32/18
11.	8013020003					SCREW	item	4
12.	8003000017					NUT AND WASHER	item	12
13.	8013000037					SCREW	item	8

EVOLUTION (WALL MOUNTED. STAINLESS STEEL)									
Pos.	Ø100 L=2.1m	Ø100 L=2.7m	Ø125 L=3m	Ø125 L=4m	Ø150 L=3m	Ø150 L=4m	Description	Unit	Qty.
	Code	Code	Code	Code	Code	Code			
1.	3000006605	3000001224	3000000817		3000000676		BRACKET + SLEWING BEARING BLOCK	item	1
	3000009194	/					BRACKET ATTACHMENT EXTENSION	item	1
2.	3000009814	3000001136		3000001137	3000000684	3000000697	JOINTED MOUNT	item	1
3.	3000001066	3000001065	3000000831		3000000637		FLEXIBLE HOSE	item	1
4.	3000001235	3000002715	3000001253	3000001252	3000001241	3000001242	STAINLESS STEEL PIPE	PZ	1
5.	3000001065	3000010459	3000000830		3000000638		FLEXIBLE HOSE	item	1
6.	3000003099	3000002716	3000003113	3000003114	3000002931	3000002934	STAINLESS STEEL PIPE AND SHUTTER	item	1
7.	3000002674		3000003586		3000002950		COMPLETE FINAL JOINT	item	1
8.	3000002675		3000003528		3000002727		COMPLETE HOOD	item	1
9.	7035000065		7035000061		7045030023		HOSE CLIPS	item	4
10.	8009000012				8009000012		RIVET	item	16/32
11.	8013000029	8013020003					SCREW	item	4
12.	8003000017		8003000017			NUT AND WASHER	item	4/12	
13.	/		8013000037			SCREW	item	8	

EVOLUTION (TROLLEY MOUNTED)

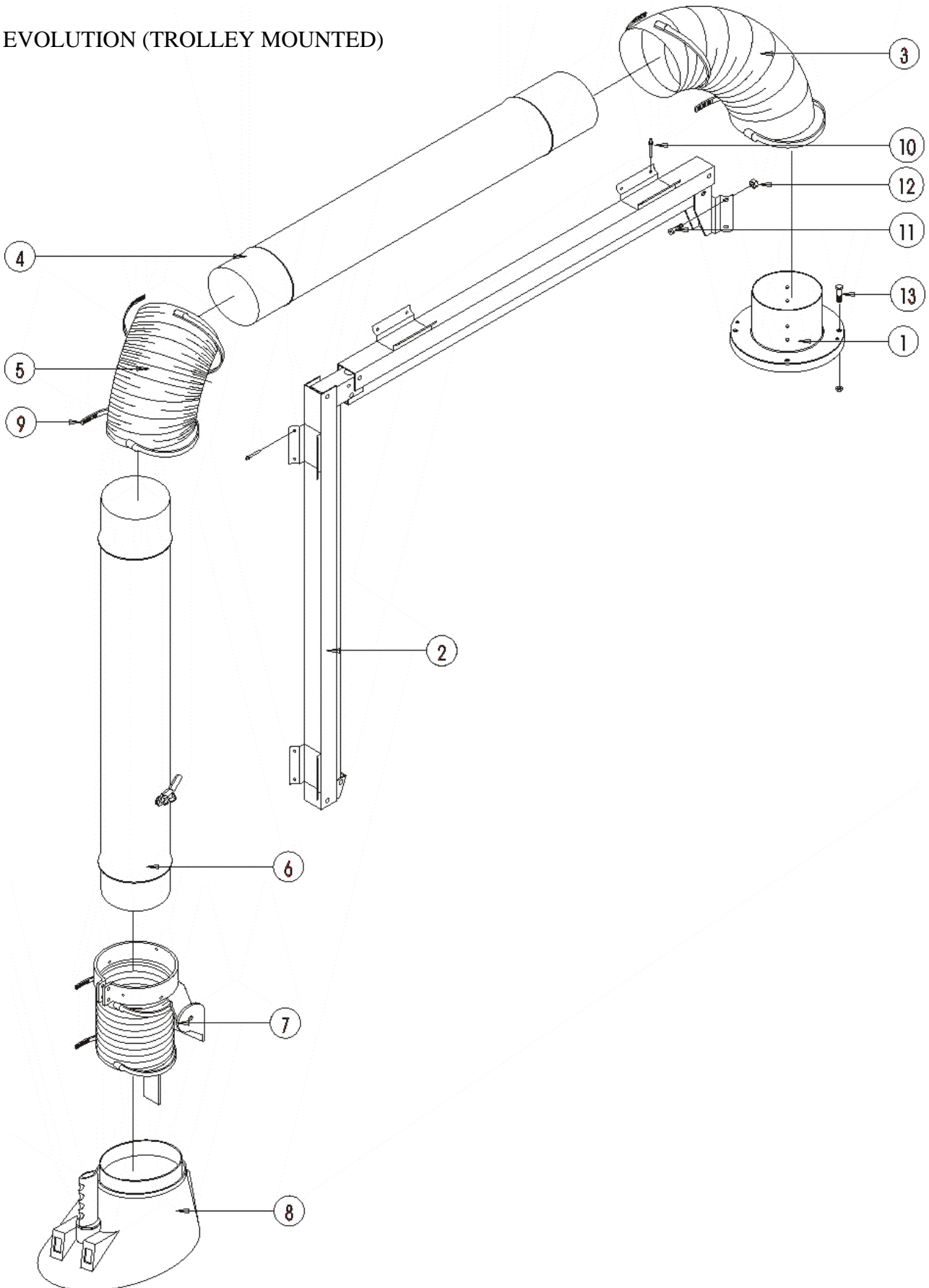

EVOLUTION (TROLLEY MOUNTED, GALVANISED)								
Nr.	Ø125 L=3m	Ø125 L=4m	Ø150 L=3m	Ø150 L=4m	Description	Unit	Qty.	
	Code	Code	Code	Code				
1.	3000000808		3000000711		SLEWING BEARING (EXPLODED)	item	1	
2.	3000000656	3000000707	3000000656	3000000707	JOINTED MOUNT	item	1	
3.	3000000829		3000000636		FLEXIBLE HOSE	item	1	
4.	3000001249	3000001249	3000000665	3000000700	GALVANISED STEEL PIPE	item	1	
5.	3000010460		3000010464		FLEXIBLE HOSE	item	1	
6.	3000003111	3000003112	3000002793	3000002932	GALVANISED PIPE AND SHUTTER	item	1	
7.	3000010462		3000002950		COMPLETE FINAL JOINT	item	1	
8.	3000003528		3000002727		COMPLETE HOOD	item	1	
9.	7035000061		7045030023		HOSE CLIPS	item	4	
10.	8009000012					RIVET	item	32
11.	8013020003					SCREW	item	4
12.	8003000017					NUT AND WASHER	item	12
13.	8013000037					SCREW	item	8

EVOLUTION (TROLLEY MOUNTED. PRE-COATED)									
Nr.	Ø100 L=2.1m	Ø100 L=2.7m	Ø125 L=3m	Ø125 L=4m	Ø150 L=3m	Ø150 L=4m	Description	Unit	Qty.
	Code	Code	Code	Code	Code	Code			
1.	3000001208		3000000808		3000000711		SLEWING BEARING (EXPLODED)	item	1
2.	3000001047	3000001117	3000000656	3000000707	3000000656	3000000707	JOINTED MOUNT	item	1
3.	3000001063		3000000829		3000000636		FLEXIBLE HOSE	item	1
4.	3000001060	3000002717	3000001244	3000001245	3000000664	3000000698	PRE-COATED STEEL PIPE	item	1
5.	3000007639		3000010460		3000010464		FLEXIBLE HOSE	item	1
6.	3000003096	3000002718	3000003109	3000003110	3000002724	3000002787	PRE-COATED PIPE AND SHUTTER	item	1
7.	3000002674		3000010462		3000002950		COMPLETE FINAL JOINT	item	1
8.	3000002675		3000003528		3000002727		COMPLETE HOOD	item	1
9.	7035000065		7035000061		7045030023		HOSE CLIPS	item	4
10.	8009000012				8009000012		RIVET	item	16/32
11.	8013020003						SCREW	item	4
12.	8003000017						NUT AND WASHER	item	12
13.	8013000037						SCREW	item	8

EVOLUTION (TROLLEY MOUNTED, ALUMINIUM)									
Nr.	Ø100 L=2.1m	Ø100 L=2.7m	Ø125 L=3m	Ø125 L=4m	Ø150 L=3m	Description	Unit	Qty.	
	Code	Code	Code	Code	Code				
1.	3000001208		3000000808		3000000711	SLEWING BEARING (EXPLODED)	item	1	
2.	3000001047	3000001117	3000000656	3000000707	3000000656	JOINTED MOUNT	item	1	
3.	3000001063		3000000829		3000000636	FLEXIBLE HOSE	item	1	
4.	3000001229	3000002712	3000000826	3000000827	3000000668	ALUMINIUM PIPE	item	1	
5.	3000007639		3000010460		3000010464	FLEXIBLE HOSE	item	1	
6.	3000003097	3000002713	3000003106	3000003107	3000002930	ALUMINIUM PIPE AND SHUTTER	item	1	
7.	3000002674		300010462		3000002950	COMPLETE FINAL JOINT	item	1	
8.	3000002675		3000003528		3000002727	COMPLETE HOOD	item	1	
9.	7035000065		7035000061		7045030023	HOSE CLIPS	item	4	
10.	8009000012				8009000012	RIVET	item	16/32	
11.	8013020003						SCREW	item	4
12.	8003000017						NUT AND WASHER	item	12
13.	8013000037						SCREW	item	8



ANTIPOLLUTION SYSTEMS

EVOLUTION (TROLLEY MOUNTED, ALUMINIUM)								
Nr.	Ø150 L=4m	Ø180 L=3m	Ø180 L=4m	Ø200 L=3m	Ø200 L=4m	Description	Unit	Qty.
	Code	Code	Code	Code	Code			
1.	3000000711	3000000730		3000000790		SLEWING BEARING (EXPLODED)	item	1
2.	3000000707	3000000656	3000000707	3000000656	3000000707	JOINTED MOUNT	item	1
3.	3000000636	3000000757		3000000776		FLEXIBLE HOSE	item	1
4.	3000000702	3000000737	3000000738	3000000774	3000000775	ALUMINIUM PIPE	item	1
5.	3000010464	3000000758		3000000777		FLEXIBLE HOSE	item	1
6.	3000002933	3000002826	3000002820	3000002856	3000002877	ALUMINIUM PIPE AND SHUTTER	item	1
7.	3000002950	3000002825		3000002852		COMPLETE FINAL JOINT	item	1
8.	3000002727	3000002814		3000002850		COMPLETE HOOD	item	1
9.	7045030023	7035000056		7035000054		HOSE CLIPS	item	4
10.	8009000012	8009000012				RIVET	item	32/18
11.	8013020003				SCREW	item	4	
12.	8003000017				NUT AND WASHER	item	12	
13.	8013000037				SCREW	item	8	

EVOLUTION (TROLLEY MOUNTED. STAINLESS STEEL)									
Nr.	Ø100 L=2.1m	Ø100 L=2.7m	Ø125 L=3m	Ø125 L=4m	Ø150 L=3m	Ø150 L=4m	Description	Unit	Qty.
	Code	Code	Code	Code	Code	Code			
14.	3000001208		3000000808		3000000711		SLEWING BEARING (EXPLODED)	item	1
15.	3000001047	3000001117	3000000656	3000000707	3000000656	3000000707	JOINTED MOUNT	item	1
16.	3000001063		3000000829		3000000636		FLEXIBLE HOSE	item	1
17.	3000001235	3000002715	3000001253	3000001252	3000001241	3000001242	STAINLESS STEEL PIPE	item	1
18.	3000007639		3000010460		3000010464		FLEXIBLE HOSE	item	1
19.	3000003099	3000002716	3000003113	3000003114	3000002931	3000002934	STAINLESS STEEL PIPE AND SHUTTER	item	1
20.	3000002674		3000010462		3000002950		COMPLETE FINAL JOINT	item	1
21.	3000002675		3000003528		3000002727		COMPLETE HOOD	item	1
22.	7035000065		7035000061		7045030023		HOSE CLIPS	item	4
23.	8009000012				8009000012		RIVET	item	16/32
24.	8013020003				SCREW	item	4		
25.	8003000017				NUT AND WASHER	item	12		
26.	8013000037				SCREW	item	8		