

| REVISIONS |             |         |          |
|-----------|-------------|---------|----------|
| REV       | DESCRIPTION | DATE/BY | APPROVED |
|           |             |         |          |

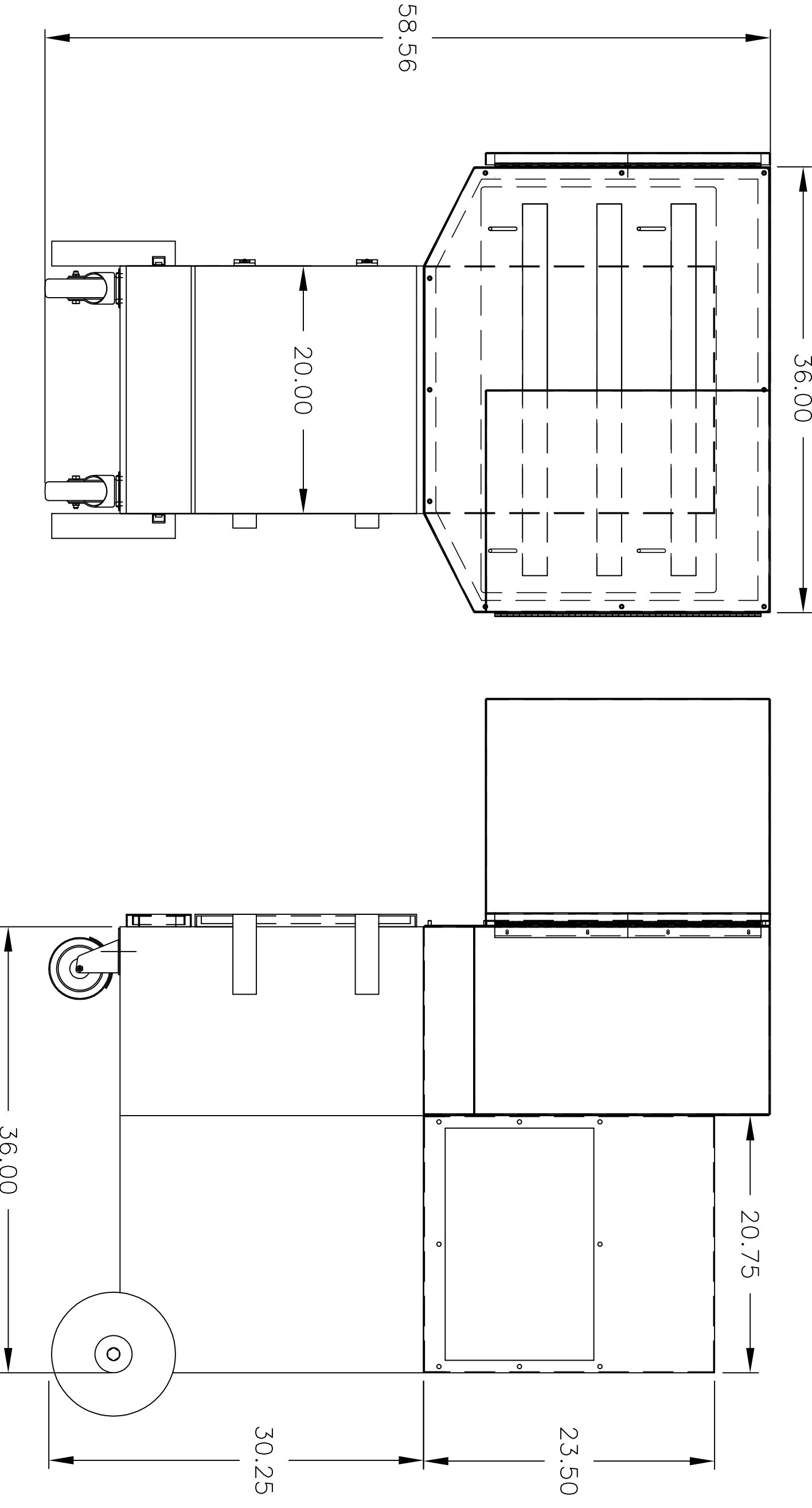

**AER** 416 S. CHERRY STREET  
 P.O. BOX 1468  
 WALLINGFORD, CT. 06492  
 Control Systems 1.888.265.2372

TITLE: SMALL PORTABLE CARTRIDGE UNIT WITH BACKDRAFT TOP

DWG. NO.: 9/19/2022

SCALE: ~ SHEET: 1 of 1

REVISION: 00

MATERIAL: ~  
 REFERENCE:  
 WEIGHT:  
 DATE:

DWN.: Gabelmann  
 DATE: 9/19/22  
 CHK.:  
 DATE:  
 APVD:  
 DATE:

DO NOT SCALE  
 ALL DIMENSIONS ARE OUTSIDE U.O.S.

TOLERANCES 2 PL= UNLESS OTHERWISE SPECIFIED ANGLES= 3 PL=

THIRD ANGLE PROJECTION  
 ALL DIMENSIONS ARE OUTSIDE U.O.S.

DWG. SIZE B

THIS DOCUMENT CONTAINS PROPRIETARY INFORMATION OF AER CONTROL SYSTEMS. ALL RIGHTS TO MANUFACTURE, COPY, OR REPRODUCE THIS DRAWING OR ITS CONTENTS ARE RESERVED BY AER CONTROL SYSTEMS, INC.